





VALVE BODY M4 TYPE T

ART. NO. 400001

GENERAL

-  The KEOFITT CLASSIC M4 Sampling Valve is the smallest KEOFITT sampling valve. Numerous standard process connections, membranes and valve heads allow for +120 M4 valve configurations. Unique serial number engraved in each valve ("E" = internal electro)
-  Designed for sampling of liquids with a viscosity of up to approx. 100 cP containing no particles larger than Ø1,5 mm. Sampling of more viscous liquids is possible, only will it take longer (depending on process pressure).
-  Cleaning/sterilizing: Between batches: Valve in open position: Cleanable by means of CIP using the detergent solution suitable for the actual process media (EHEDG certificate available). Between samples: Valve in its normal closed position: cleanable by CIP as "Between batches" or the valve may be sterilized by means of steam SIP (EHEDG test report available) or chemical SIP using a procedure appropriate to the actual circumstances. For further advice, please contact Keofitt.
-  The sampling valve can be used for any process sampling for microbiological, chemical and/or physical analysis.



FEATURES

-  Installation: Tank welding
-  Operation: Depending on choice of valve head
-  Inlet / Outlet: Hose piece
-  Membrane: Depending on choice of valve head

CERTIFICATION*

· EHEDG CIP · Conforms to 3-A · 3.1 Material Certificate · EU 1935/2004 · Ra Cert. incl. measurements

TECHNICAL DATA

Material (product contact)

- Steel parts AISI 316L (1.4404)

Material (without product contact)

- Steel parts AISI 316L (1.4404)
- Rubber cap EPDM (black)
- Stainless steel chain Stainless steel

Surface Treatment

- Outside Electropolished Ra <= 1.2 µm
- Inside (wetted surface) Electropolished Ra <= 0.5 µm
- Process connection Electropolished Ra <= 0.5 µm

Pressure & Temperature

- Pressure Depending on choice of valve head
- Temperature Depending on choice of valve head
- Air supply Depending on choice of valve head

Net Weight





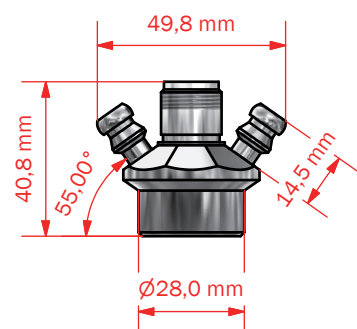
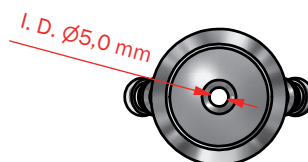
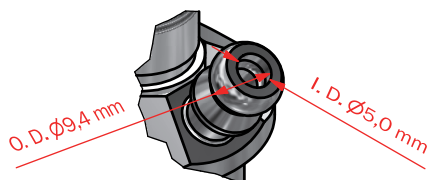
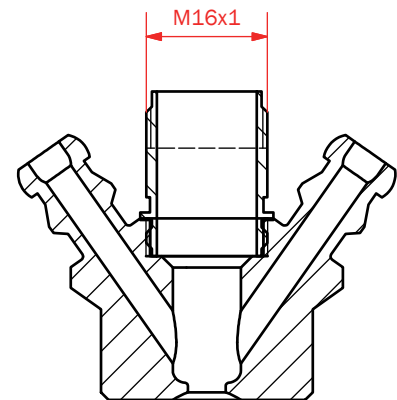

- Kg/lbs 0,148 kg /0,32 lbs

Spareparts

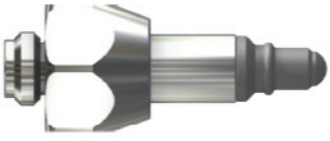
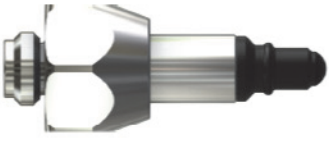
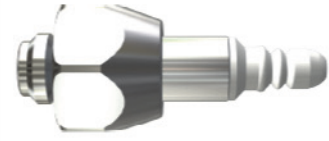
- 774001 PARTS FOR M4 BODY 400001/11/14/21/22



M 4 HEADS

	Silicone 0 °C to +150 °C	EPDM 0 °C to +130 °C	PTFE 0 °C to +130 °C
Type H Turn knob 0-6 bar (g)	 <p>400041</p>	 <p>400041E</p>	 <p>405541</p>
Type K Key ring 0-6 bar (g)	 <p>400042</p>	 <p>400042E</p>	 <p>405542</p>
Key Ring for valve head	 <p>400076</p>	 <p>400076</p>	 <p>400076</p>
Type Q Lever handle 0-6 bar (g)	 <p>400043</p>	 <p>400043E</p>	 <p>405543</p>
Type N Pneumatic 0-6 bar (g)	 <p>400044</p>	 <p>400044E</p>	 <p>405544</p>
Type B No spring 0-12 bar (g)	 <p>400047</p>	 <p>400047E</p>	 <p>405547</p>